

*** Outline Dimension(mm)**

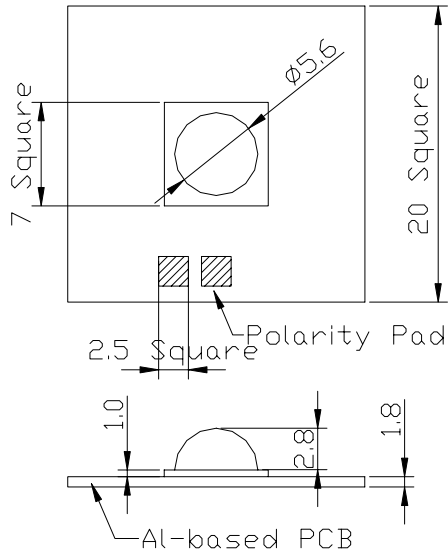

*** Far Field Pattern**

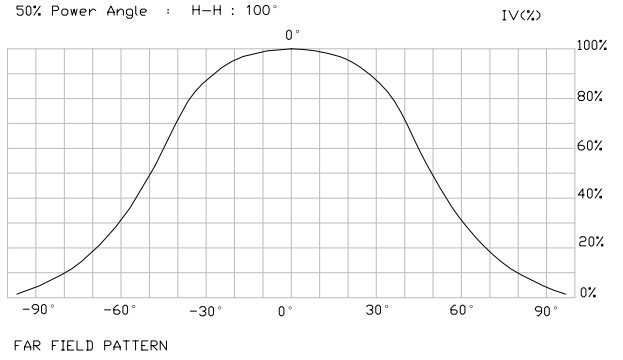

*** Optical-Electrical Characteristics**

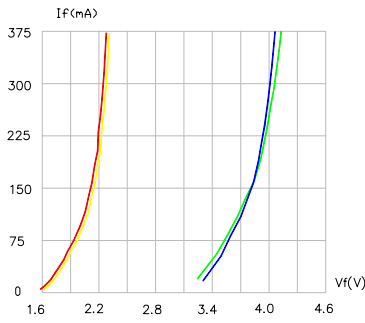

FIG.1 FOWARD CURRENT VS. FORWARD VOLTAGE

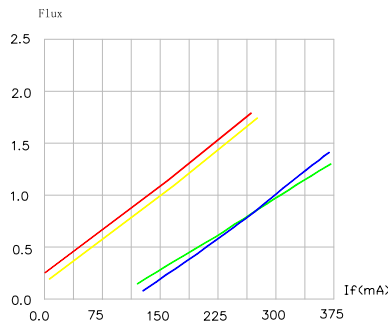

FIG.2 RELATIVE LUMINOUS INTENSITY VS. FORWARD CURRENT.

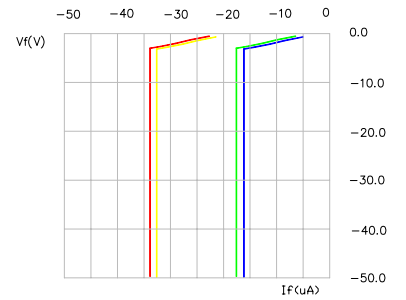

FIG.3 REVERSE CURRENT VS. REVERSE VOLTAGE.

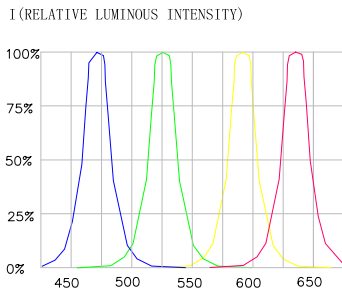

FIG.4 RELATIVE LUMINOUS INTENSITY VS. WAVELENGTH.

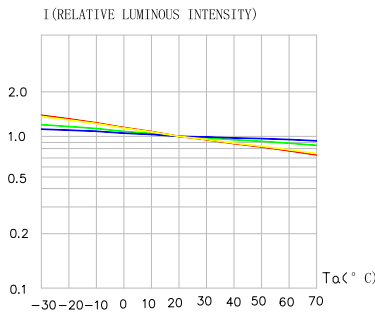

FIG.5 LUMINOUS INTENSITY VS. AMBIENT TEMPERATURE.

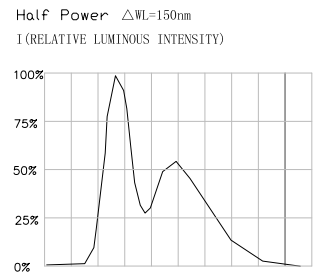
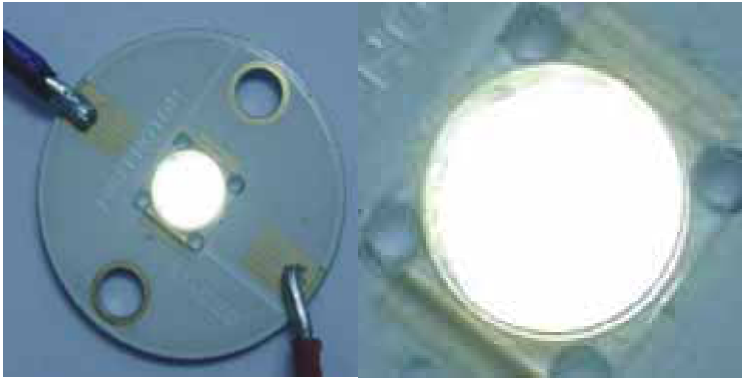

FIG.6 RELATIVE LUMINOUS INTENSITY VS. WAVELENGTH.(only for white LED)



.Features

- . High luminous flux output
- . Reliable and rugged
- . High current operation

.Application

- . Illuminations;

Part NO.	Viewing Angle (deg)	Lens Color	Chip			Flux(lm)	Power(w)	Vf(V)
			Material	Emitting Color	AD(nm) or Chromatic Coordinates(x,y)(typ)	IF=150mA	IF=150mA	IF=150mA
						Typ	Typ	Typ
WCN-HP05HR-00	100	Water Clear	AlInGaP	Red	624	8	0.3	2.2
WCN-HP05HA-00	100	Water Clear	AlInGaP	Amber	605	8	0.3	2.2
WCN-HP05HY-00	100	Water Clear	AlInGaP	Yellow	590	8	0.3	2.2
WCN-HP05PG-00	100	Water Clear	AlInGaN	Pure Green	525	8	0.5	4.0
WCN-HP05CB-00	100	Water Clear	AlInGaN	Blue	470	8	0.5	4.0
WCN-HP05HW-00	100	Water Clear	AlInGaN	White	(0.31,0.32)	8	0.5	4.0

Part NO.	Viewing Angle (deg)	Lens Color	Chip			Flux(lm)	Power(w)	Vf(V)
			Material	Emitting Color	AD(nm) or Chromatic Coordinates(x,y)(typ)	IF=300mA	IF=300mA	IF=300mA
						Typ	Typ	Typ
WCN-HP05HR-01	100	Water Clear	AlInGaP	Red	624	15	0.7	2.2
WCN-HP05HA-01	100	Water Clear	AlInGaP	Amber	605	15	0.7	2.2
WCN-HP05HY-01	100	Water Clear	AlInGaP	Yellow	590	15	0.7	2.2
WCN-HP05PG-01	100	Water Clear	AlInGaN	Pure Green	525	15	1.2	4.0
WCN-HP05CB-01	100	Water Clear	AlInGaN	Blue	470	15	1.2	4.0
WCN-HP05HW-01	100	Water Clear	AlInGaN	White	(0.31,0.32)	15	1.2	4.0